

multibox

Instructions



Multibox Parts Include:

Part A (x3) - Box Frame

Part B (x3) - Box Bottom

Part C (x3) - Lid

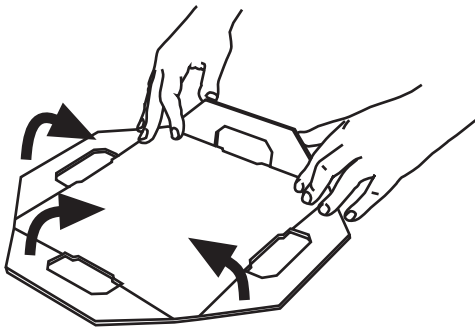
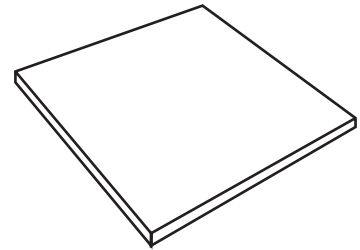
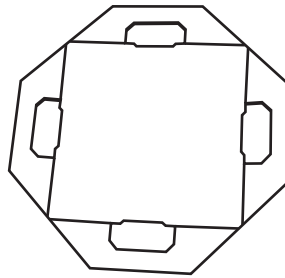
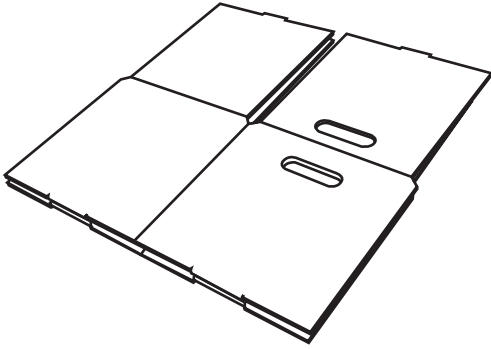

a. With Part B facing up, fold all 4 sides in a 90° angle.

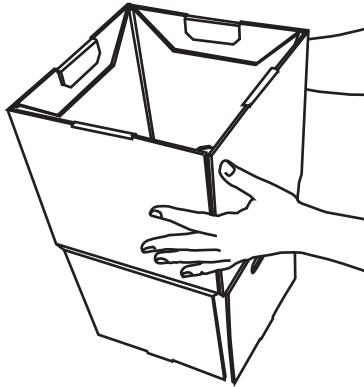

b. Open up Part A, and hold as shown.

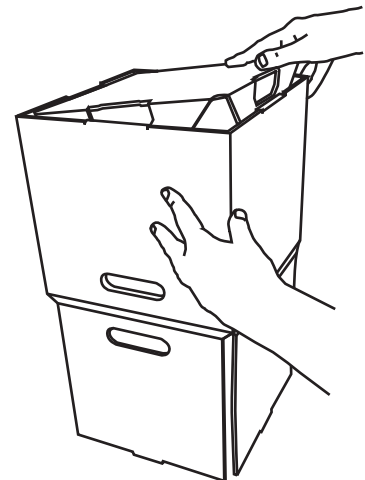

c. Insert Part B into Part A as shown.

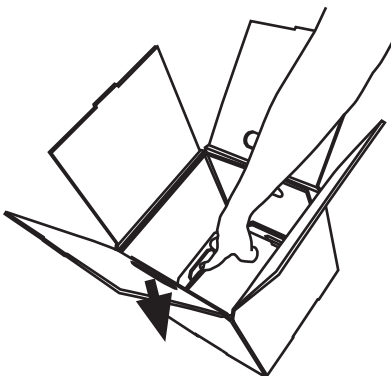

d. Turn box over. Reach in and fold part B sides inward. Remove paper cover of adhesive pads. Push Part B sides back firmly into place.

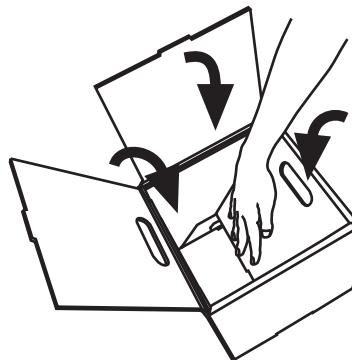

e. Fold all 4 sides of Part A inward.

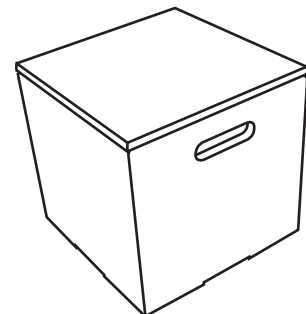

f. Place lid on.

Do not use if any part is broken torn or missing

GREEN
LULLABY
cardboard made